



The NSW Government has committed \$30 million to providing comprehensive, accessible, culturally welcoming and consumer friendly health care services to support the needs of the entire Wentworth community.

The new hospital will include a 19-bed Inpatient Unit, with a direct view of the Darling River from all bedrooms, Primary Ambulatory Care (Community Health Services), and an Urgent Care Centre.

Other features include:



A light-filled family and dining room



A palliative care suite, which includes an inpatient room with a private terrace and an adjacent family lounge with views to the river



A dedicated space for families, which opens to a central, shared courtyard



A gym with access to outdoor courtyard



Outdoor spaces and landscaping which focus on connection to Country, including a Yarning Circle and native plants.

Progress so far

In July 2022 it was announced that the existing hospital site overlooking the Darling River was the preferred site for the redevelopment, a decision which received positive feedback. The Master Plan was also unveiled, outlining the vision for the new facility on the banks of the Darling River.

The Concept Design was announced in October 2022, followed by the Schematic Design in March 2023 which was informed by staff, community and stakeholder feedback. Detailed Design for the redevelopment is now complete.

The competitive tender process for the main works contractor is underway and the contractor is expected to be announced in the coming weeks, with construction to start shortly after.

Building to start soon!

It's not long now until construction starts on the new Wentworth Health Service.

Keep your eye out for fencing and signs to be erected on the site soon, signaling the start of work.



Unique design with Connecting to Country focus

The Concept and Schematic Designs for the redevelopment were developed through consultation with staff and the community, including Traditional Owners, and showcase what the new hospital will look like when it is completed.

The new hospital is being built adjacent to the existing hospital and will be raised above the flood levee, which will also maximise views over the Darling River. The location is significant to the local Aboriginal community with connection to Country being a key focus to the design.

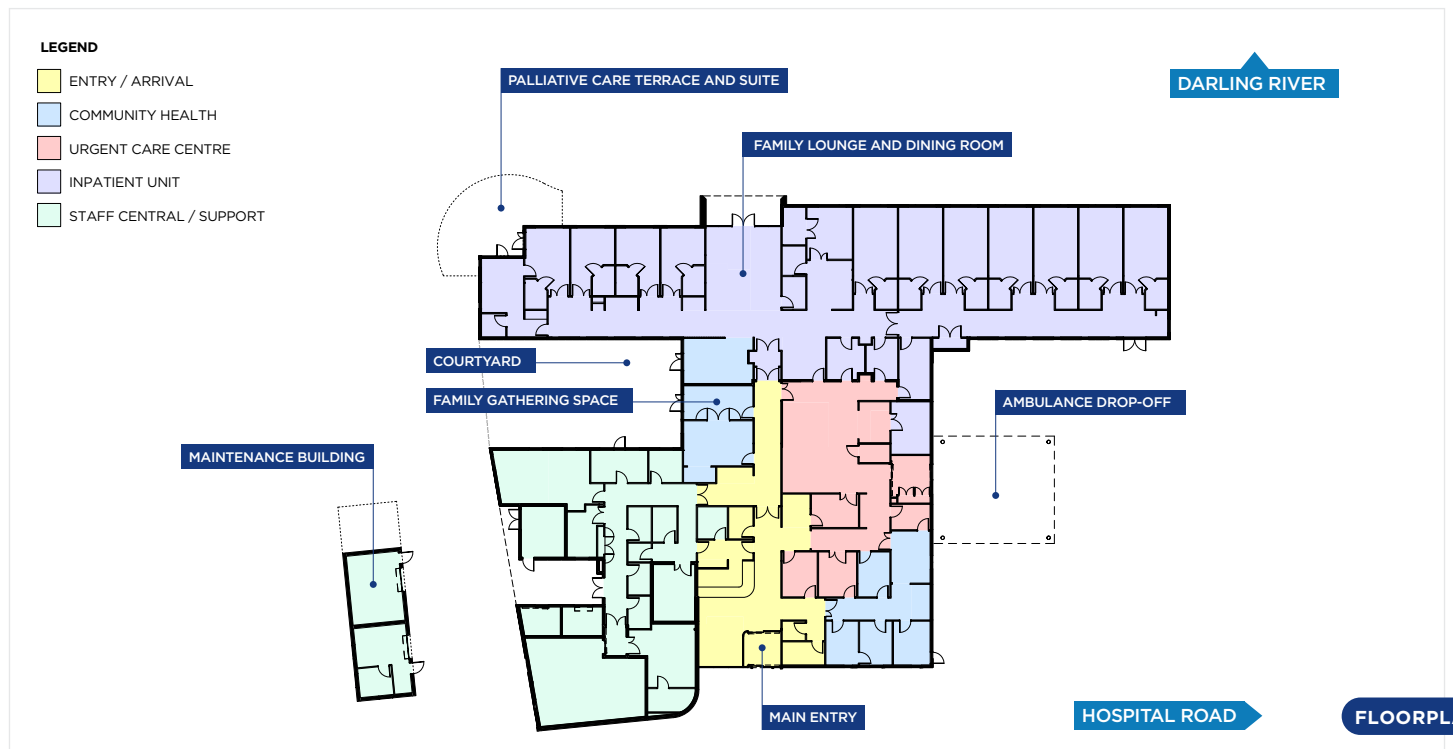

Arts to reflect culture and history

Exposure to the arts has many benefits for the health and wellbeing of patients and has been another key aspect in the project to date.

Following an Expression of Interest process, a local Arts Working Group was established earlier this year to initiate the integration of arts into the project design. With the support of Health Infrastructure's innovative Arts in Health program, the group explored how arts can help deliver welcoming, dynamic, and culturally appropriate spaces for patients, staff and the community in the new hospital.

One of the artwork packages will focus on celebrating local Barkindji history, Country and culture. The second artwork package will centre around the history of the hospital, acknowledging its 80+ year history and the important role it has played in the Wentworth community.

To ensure this rich history is reflected in the new facility, we are working with the local community to develop a history display to celebrate the Health Service's past and to connect patients and visitors with the social history of their town.

We have sought feedback from hospital staff and the Wentworth Historical Society to inform the history display, and are also welcoming ideas from other community members, many of whom have connections to, and memories of, the Wentworth Hospital.

Next steps

The announcement of the successful contractor is expected in the coming weeks.

The community will be kept informed with regular updates and work notifications throughout the construction phase.

Once the new hospital is fully operational, the existing hospital will be demolished. This will enable the construction of a new ambulance drop-off bay, and further landscaped areas for patients and their families.

More information

For more information about the Wentworth Health Service Redevelopment, you can contact the project team as follows:

Phone: (02) 8838 8889

Email: HI-Wentworth@health.nsw.gov.au

Website: wentworthredevelopment.health.nsw.gov.au



To share your ideas, stories and memories of the Health Service, please complete the online History Display survey accessible at: rb.gy/18hgi or scan the QR code.

The survey closes on Monday, 29 September 2023.



FOR MORE INFORMATION ABOUT THE REDEVELOPMENT:

Web: wentworthredevelopment.health.nsw.gov.au

Email: HI-Wentworth@health.nsw.gov.au

Phone: (02) 8838 8889